

Stanley Boyd
K-5 Functional Space Program

1/14/2022
 600 students

| Space/Group | QTY | SF | New Subtotal | Remodel Subtotal | Comments |
|-------------------------------|-----|-------|---------------|------------------|--------------------|
| General Classroom Area | | | | | |
| Kindergarten | 5 | 1,000 | 5,000 | 0 | Shared |
| K-Storage | 3 | 200 | 600 | 0 | |
| K Toilets | 5 | 50 | 250 | 0 | |
| 1st Grade- 3rd Grade | 15 | 900 | 13,500 | 0 | |
| 4th Grade- 5th Grade | 8 | 900 | 7,200 | 0 | |
| Storage | 5 | 200 | 1,000 | 0 | |
| Small Group | 6 | 120 | 720 | 0 | |
| Group Learning | 6 | 1,000 | 6,000 | 0 | |
| Subtotal | | | 34,270 | 0 | |
| MISC Elementary Spaces | | | | | |
| Gifted & Talented | 1 | 900 | 900 | 0 | For bubble classes |
| Flex Classrooms | 2 | 900 | 1,800 | 0 | |
| STEAM Room | 0 | 1,200 | 0 | 0 | Use Existing |
| Storage | 0 | 100 | 0 | 0 | |
| Music | 1 | 1,200 | 1,200 | 0 | |
| Storage | 1 | 300 | 300 | 0 | |
| Art Room | 1 | 1,200 | 1,200 | 0 | |
| Storage | 1 | 200 | 200 | 0 | |
| Kiln | 1 | 100 | 100 | 0 | |
| Subtotal | | | 5,700 | 0 | |
| Special Needs | | | | | |
| SPED | 1 | 600 | 600 | 0 | |
| SPED | 2 | 400 | 800 | 0 | |
| Focus if any / seclusion | 0 | 150 | 0 | 0 | |
| ECSE | 0 | 990 | 0 | 0 | |
| Storage | 0 | 200 | 0 | 0 | |
| Toilet / Changing | 0 | 100 | 0 | 0 | |
| Reading, Title and Speech | 4 | 200 | 800 | 0 | |
| OT | 1 | 200 | 200 | 0 | |
| PT/Dape Storage | 0 | 150 | 0 | 0 | |
| Conference Room | 1 | 150 | 150 | 0 | |
| Subtotal | | | 3,450 | 0 | |

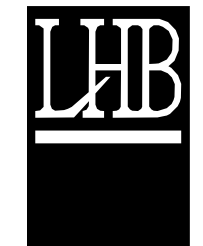

PERFORMANCE
DRIVEN DESIGN.
LHBcorp.com

21 W. Superior St., Ste 500 | Duluth, MN 55802 | 218.727.8446

CLIENT:
**STANLEY-BOYD
AREA SCHOOLS**

507 EAST 1ST AVE
STANLEY, WI 54768

KEYPLAN

THIS SQUARE APPEARS 1/2"x1/2"
ON FULL SIZE SHEETS

| NO | DATE | ISSUED FOR |
|----|------|------------|
| | | |
| | | |
| | | |
| | | |
| | | |
| | | |
| | | |
| | | |
| | | |
| | | |

| NO | DATE | REVISION |
|----|------|----------|
| | | |
| | | |
| | | |
| | | |
| | | |
| | | |
| | | |
| | | |
| | | |
| | | |

COPYRIGHT 2021 BY LHB, INC. ALL RIGHTS RESERVED.

PROJECT NAME:
**STANLEY-BOYD
ELEMENTARY &
MIDDLE SCHOOL
RENOVATION**

DRAWING TITLE:
LEVEL 2 FLOOR PLAN

DRAWN BY:
CHECKED BY:
PROJ. NO:
DRAWING NO:

A102



= AREA OF RENOVATION

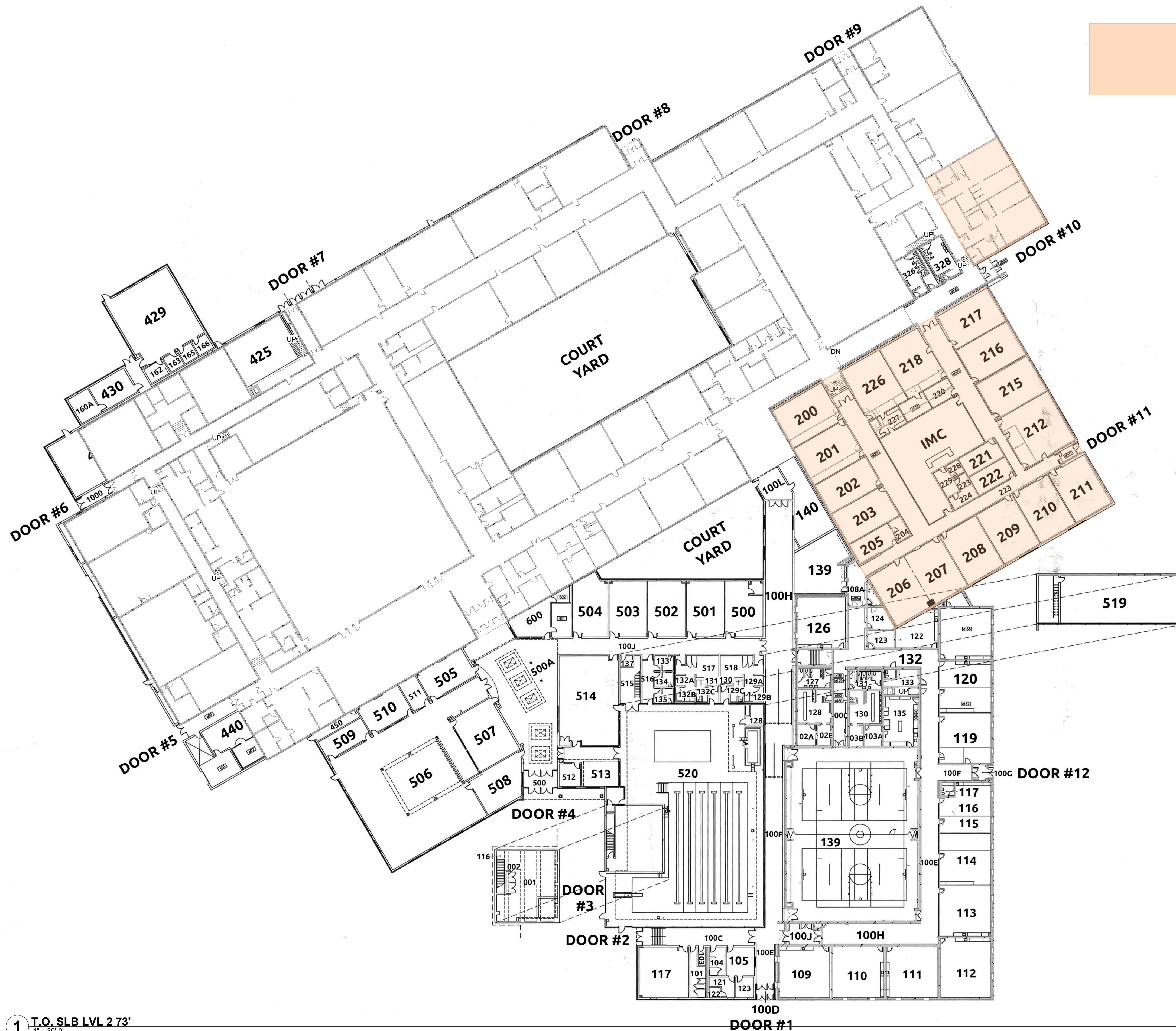

1 T.O. SLB LVL 2 73'
1" = 30'-0"

BIM 360://210598 Stanley_Boyd/210598 Stanley_Boyd A20.rvt
1/12/2022 2:20:20 PM

| Stanley Boyd Elementary/Middle School Renovations | | | | | | | | | | | | | | | | | | | | | |
|---|--------|--------|--------|--------|--------|--------|--------|--------|--------|--------|--------|--------|--------|--------|--------|--------|--------|--------|--------|--------|--------|
| Task | Jan-22 | Feb-22 | Mar-22 | Apr-22 | May-22 | Jun-22 | Jul-22 | Aug-22 | Sep-22 | Oct-22 | Nov-22 | Dec-22 | Jan-23 | Feb-23 | Mar-23 | Apr-23 | May-23 | Jun-23 | Jul-23 | Aug-23 | Sep-23 |
| Field Investigation/Bldg Model | █ | █ | | | | | | | | | | | | | | | | | | | |
| Programming/Block Plans | | █ | █ | █ | | | | | | | | | | | | | | | | | |
| Site Visits | | █ | █ | █ | | | | | | | | | | | | | | | | | |
| Board Apporval on Project Scope | | | █ | | | | | | | | | | | | | | | | | | |
| Design/Construction Documents | | | █ | █ | █ | █ | █ | █ | █ | █ | █ | █ | █ | | | | | | | | |
| Owner/CESA/PEER Review | | | | | | █ | | | | █ | | | | | | | | | | | |
| Bidding (4 Weeks) | | | | | | | | | | | █ | █ | █ | █ | | | | | | | |
| Board Approval | | | | | | | | | | | | █ | █ | █ | | | | | | | |
| Contract | | | | | | | | | | | | | █ | █ | | | | | | | |
| Submittal Reviews/Order Materials | | | | | | | | | | | | | | | █ | █ | █ | █ | █ | █ | █ |
| Demolition (2 Weeks) | | | | | | | | | | | | | | | | | | █ | █ | | |
| Construction (11 Weeks) | | | | | | | | | | | | | | | | | | | █ | █ | █ |